

# FLOWMETER TYPE L

Air, water, Gases - 316 Stainless Steel threads, Connectors, Valve

## TECHNICAL DATA

Max. Pressure	20 bar (30 bar @ 30°C)
Max. Temperature	LH -75 °C, LR - 80 °C, LT - 70 °C
Accuracy	±10% v.f.s. (H <sub>2</sub> O a 20 °C)
Body materials	LH - Acrylic (PMMA) LR - Grilamid TR 55 LT - Trogamid T
Gasket	Nitrile Viton - EPDM on demand
Connectors, Valve	316 Stainless Steel
Threads	NPT 1/4" Back Male
Weight	300 gr

## SPECIAL EXECUTIONS ON DEMAND

- Calibration for non-standard gases and liquids (Special Range)
- Special scale markings
- Special seals

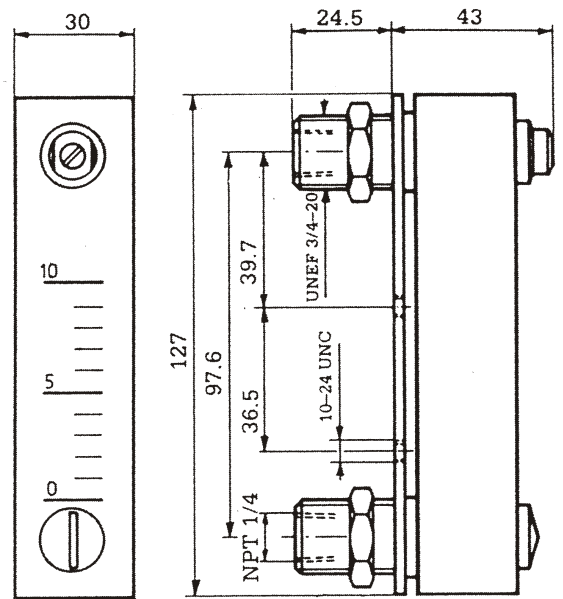

## ORDERING CODE

L H 5B A H

TYPE L

MATERIALS H - R - T

RANGE	H <sub>2</sub> O (+20 °C)	AIR* (+20 °C / 101,3 kPa)
4K	2 ÷ 18 ml/min	0,1 ÷ 0,9 nl/min
4A	2,5 ÷ 30 ml/min	0,1 1,2 nl/min
4B	5 ÷ 50 ml/min	0,2 ÷ 1,8 nl/min
4C	15 ÷ 80 ml/min	0,5 ÷ 2,5 nl/min
5K	0,01 ÷ 0,13 l/min	0,5 ÷ 6 nl/min
5A	0,01 ÷ 0,20 l/min	0,5 ÷ 7 nl/min
5B	0,025 ÷ 0,3 l/min	1 ÷ 10 nl/min
5C	0,05 ÷ 0,5 l/min	2 ÷ 14 nl/min
8M	0,1 ÷ 1,0 l/min	5 ÷ 30 nl/min
8P	0,2 ÷ 1,6 l/min	5 ÷ 50 nl/min
8S	0,2 ÷ 2,6 l/min	10 ÷ 85 nl/min
8R	0,5 ÷ 3,0 l/min	10 ÷ 110 nl/min

SCALE A - R - D

OPTIONS H - R - V

## CODE EXPLANATION

### TYPE

L Flow meters 316 St. Steel Thread, Valve, Connectors

### MATERIALS

H Flowtube Acrylic (PMMA)  
R Flowtube Grilamid TR 55  
T Flowtube Trogamid T

### FLOW

See left-side label

### SCALE

A l/min of H<sub>2</sub>O  
R nl/min of Air @ 101,0 kPa @ 20 °C  
D relative scale 1-10

### OPTIONS

H Hand adjusting knob  
R 1/4" BSP Male back Threads  
V Viton gasket

\* NB when is ordered flow meter used with gases, you must indicate the working pressure in the tube. The flow meter it will always realized and setting on the supplied pressure value.