

# INSERTION MAGMETER FLOW CONTROL TYPE 8045

Flow control of liquids with/without solid state particles - DN15 ÷ DN50 - Impulse / Relay Output

8045 Magmeter is an insertion flow meter for pipe sized ½" - 2". Typical applications are liquids having a conductivity > 20 µS.

For commissioning a simulation-mode is available providing a simulation of all output signals as if there was real flow. So, the user can first simulate all flow conditions safely including alarm conditions before putting the hydraulics into action. Calibration is done by either using the standard calibration factors or the unique Teach-in function. In the latter case the unit will do an auto-calibration once installed in the particular application.

For waste water treatment, surface treatment, laundries and food industry.

## DIMENSIONS (mm)

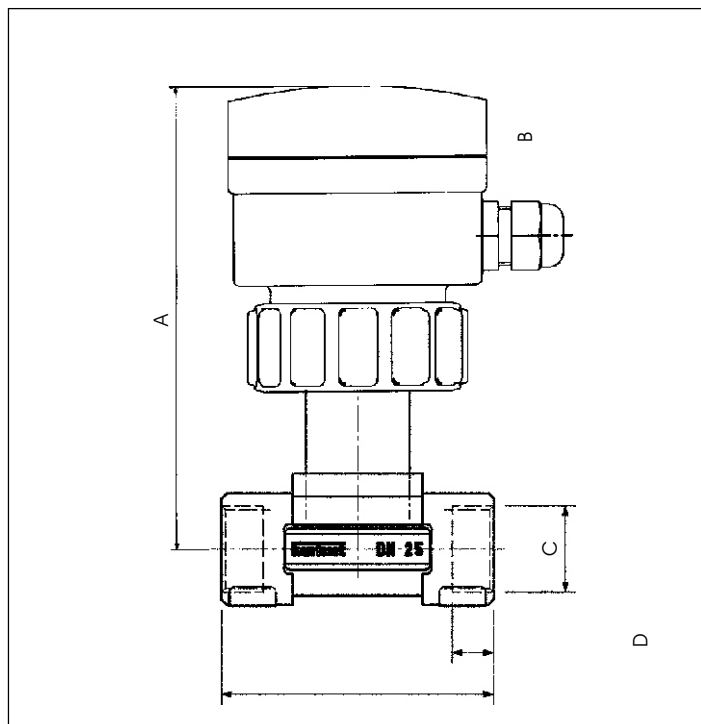
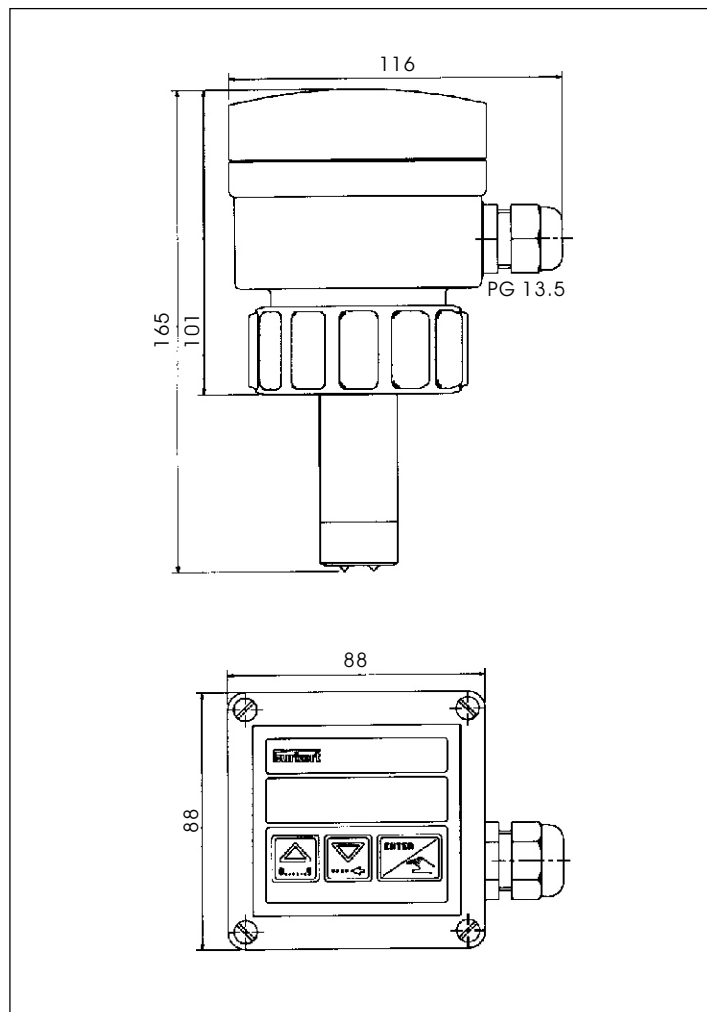

Variable dimensions [mm]

DN	A	B	C	D
15.0	173.0	85.0	G 1/2	16.0
20.0	171.0	95.0	G 3/4	17.0
25.0	171.0	105.0	G 1	23.5
32.0	177.0	120.0	G 1 1/4	23.5
40.0	178.0	130.0	G 1 1/2	23.5
50.0	184.0	150.0	G 2	27.5

## FITTINGS TYPE S020 (to be ordered separately)

### SPECIFICATIONS

### ORDERING CODE

Fitting Material	DN [mm]	Gasket Material	Code
S. Steel	15.0	FPM	428 736 Y
S. Steel	20.0	FPM	428 737 Z
S. Steel	25.0	FPM	428 738 A
S. Steel	32.0	FPM	428 739 B
S. Steel	40.0	FPM	428 740 Q
S. Steel	50.0	FPM	428 741 D
Brass	15.0	FPM	428 712 Y
Brass	20.0	FPM	428 713 Z
Brass	25.0	FPM	428 714 S
Brass	32.0	FPM	428 715 T
Brass	40.0	FPM	428 716 U
Brass	50.0	FPM	428 717 V

## INSERTION MAGMETER TECHNOLOGY

### SPECIFICATIONS

### ORDERING CODE

Description	Code
4-20 mA, Pulse, 2 x Totalizers	426 498 R

# INSERTION MAGMETER FLOW CONTROL TYPE 8045

Flow control of liquids with/without solid state particles - DN15 ÷ DN50 - Impulse / Relay Output

## Technical Data

Measuring range	0.05 - 10 m/s	Sensor material	PVDF Body, Stainless Steel Electrodes (1.4404 / 316L)
Measuring	1. With individual works calibration (On request) or Teach-In: ≤ -2% o.R. (1-10 m/s) * 2. with standard mean K-factor ≤ -4% o.R.(1-10 m/s) *	O-rings Housing Front plate foil Fittings	FPM standard PC Polyester Stainless Steel / Brass
Linearity	≤ -(1% o.R. + 0.1% o.F.S.) *	Pipe diameters	Da DN15 a DN50
Repeatability	≤ 0.25% o.R. *	Power supply	18...32 VCC, 3-fili
Temp. Coefficient	Dn15 = +0.2 % /K DN20, DN25 = +0.1 % /K <sup>1)</sup> > Dn25 = +0.05 % /K <sup>1)</sup> <sup>1)</sup> Reference temperature	Cable connector	1 x PG 13.5
Display	15x60 mm, 8 digit, LC display, Alphanumeric, 15 segment, 9 mm large	Output signal	4...20 mA
Fluid Conductivity	> 20 µS (Micro-Siemens)	Load	Max. 900 Ω @ 30 V Max. 500 Ω @ 24 V Max. 100 Ω @ 15 V
Fluid temperature	0 to 80 °C	Pulse output	Open collector NPN and PNP, 0...30 V, 100 mA, protected
Ambient temperature	0 to 60 °C	Optins	reed relay closing 0.1 s, Opening depending from Flow rate 0,1 s min. Switches Max. 34 V, 0.2 A
Storage temperature	0 to 60 °C	Relay output (option)	2 Relays, freely programmable, 3 A, 230 V
Pressure class	PN 6		
Enclosure	IP65 (NEMA4)		

\* Under reference conditions, i.e. Measuring fluid = water, ambient and water temperature = 20°C

Applying the minimum inlet and outlet pipe straights, mached indide pipe dimensions uscita, in rapporto alle dimensioni interne del tubo

O.R. = of reading

O.F.S. = of full scale (10 m/s)

- ✓ Easy commissioning due to Multi-language and menu-guided Operation
- ✓ SIMULAZTION:  
All output signals provided  
Without the need of real flow
- ✓ TEACH-IN:  
Automatic calibration in particular Applications